



300Mbps Wireless N ADSL2+ Modem Router

N300 with Proven Stability
and Flexible Internet Access

TD-W8960N



ADSL Modem
+ Wireless Router



300Mbps
Wireless Speed



Easy Setup

Features



Speed

- **300Mbps Wireless Speed** – 300Mbps Wi-Fi allows stable speed for wireless activities, such as streaming, surfing, browsing and posting social media
- **Fast Ethernet** – Fast Ethernet port for rapid, reliable wired connections to desktops, game consoles and IPTVs

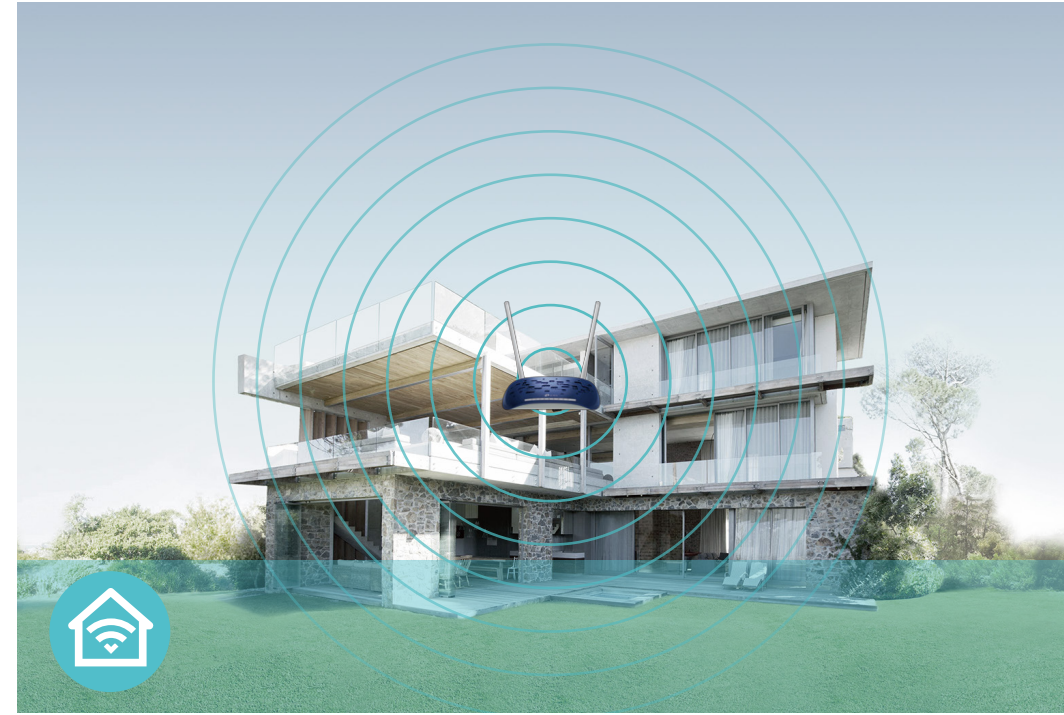

Wi-Fi Range

- **Great Coverage** – Two 5dBi external antennas expand network coverage across your home
- **Stronger Wi-Fi** – 2×2 MIMO technology improves signal stability



Reliability

- **IPv6** – Supports the latest Internet Protocol IPv6 to future-proof your network
- **IPTV** – Supports Bridge for smooth IPTV application
- **Quality of Service** – Prioritizes data transmission based on IPP/ToS, DSCP and 802.1p ATM QoS

Features



Ease of Use

- Intuitive Web UI – Ensures quick and simple installation without hassle
- Fast Encryption – Easily set up an encrypted wireless connection at a push of the WPS button
- Wi-Fi On/Off – Turn On/Off wireless radio using the Wi-Fi button
- Power On/Off – Conveniently power on or off your router as required



Security

- Guest Network – Keep your main network secure by creating a separate network for friends and visitors
- Parental Controls – Manage when and how connected devices can access the internet
- SPI and NAT Firewall – Protects end-user devices from potential attacks from the internet
- 6000V Lightning Protection – Helps your device to avoid the damage of tough thunderstorm

Specifications

Hardware

- Ports: 1 10/100Mbps LAN/WAN Port, 3 10/100Mbps LAN ports, 1 RJ11 port
- Button: WPS/Reset Button, Wi-Fi Button, Power On/Off Button
- Antenna: 2 × 5dBi Fixed Omni-Directional Antennas
- External Power Supply: 9V/0.85A
- Dimensions (W x D x H): 7.1 × 4.9 × 1.4 in. (181.6 × 125.7 × 36.2 mm)
- IEEE Standards: IEEE 802.3, 802.3u
- ADSL Standards: Full-rate ANSI T1.413 Issue 2, ITU-T G.992.1(G.DMT), ITU-T G.992.2(G.Lite), ITU-T G.994.1 (G.hs), ITU-T G.995.1
- ADSL2 Standards: ITU-T G.992.3 (G.DMT.bis), ITU-T G.992.4 (G.lite.bis)
- ADSL2+ Standards: ITU-T G.992.5

Wireless

- Wireless Standards: IEEE 802.11b, 802.11g, 802.11n
- Frequency: 2.400 - 2.4835GHz
- Signal Rate: 300Mbps at 2.4GHz
- Transmit Power: <20dBm(EIRP)
- Wireless Function: Enable/Disable Wireless Radio, WDS Bridge, WMM, Wireless Statistics
- Wireless Security: Supports 64/128-bit WEP, WPA/WPA2, WPA-PSK/WPA2-PSK encryptions, Wireless MAC Filtering

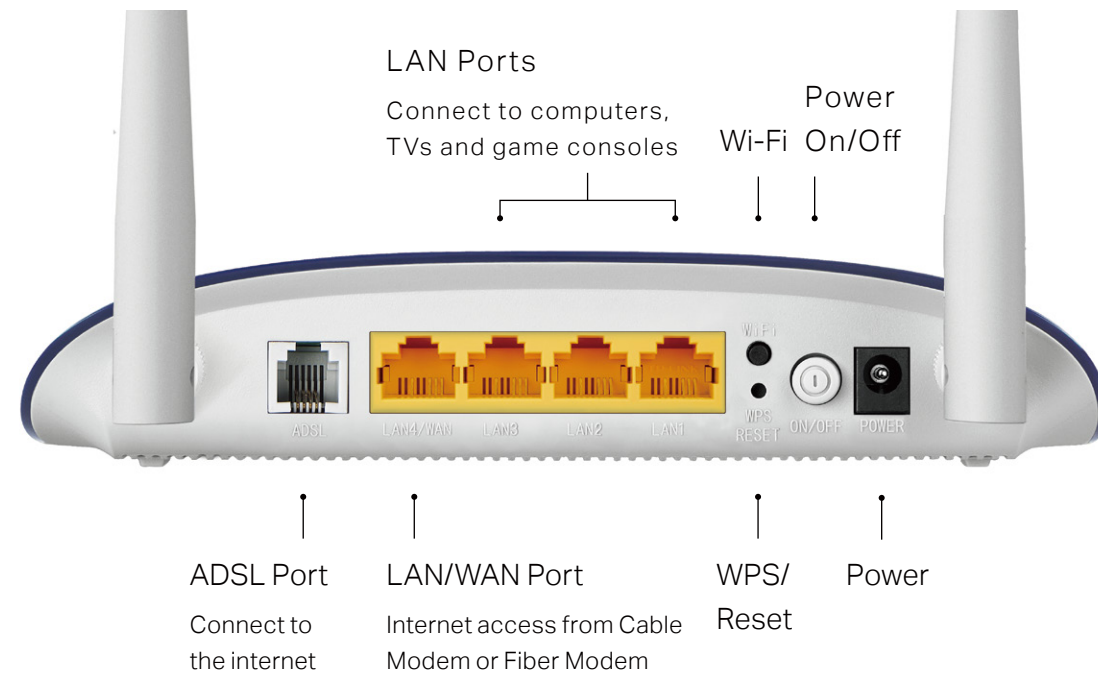

Specifications

Software

- Operation Modes: ADSL Modem Router, Wireless Router
- DHCP: Server, Client, DHCP Client List, Address Reservation, DHCP Relay
- Quality of Service: QoS Remarking based on IPP/ToS, DSCP, 802.1p ATM QoS
- Port Forwarding: Virtual Server, Port Triggering, DMZ, ALG
- Dynamic DNS: DynDns, NO-IP
- ATM/PPP Protocols: ATM Forum UNI3.1/4.0, PPP over ATM (RFC 2364), PPP over Ethernet (RFC2516), IPoA (RFC1577/2225), MER/IPvE (RFC 1483 Routed), Bridge (RFC1483 Bridge), PVC - Up to 8 PVCs
- Security: NAT Firewall, Access Control, MAC/IP/URL Filtering, Denial of Service (DoS), SYN Flooding, Ping of Death, IP and MAC Address Binding
- Management: Web Based Configuration(HTTP), Remote management, Command Line Interface, SSL for TR-069, SNMP v1/2c, Web Based Firmware Upgrade, Diagnostic Tools
- Guest Network: 2.4GHz guest network
- Protocols: Supports IPv4 and IPv6

Others

- Certification: CE, RoHS
- System Requirements:
Windows 10/8.1/8/7/Vista/XP or Mac OS or Linux-based operating system
- Environment
Operating Temperature: 0°C~40°C (32°F ~104°F)
Storage Temperature: -40°C~70°C (-40°F ~158°F)
Operating Humidity: 10%~90% non-condensing
Storage Humidity: 5%~90% non-condensing
- Package Contents
DSL Modem Router TD-W8960N
External DSL Splitter
RJ11 DSL Cable
RJ45 Ethernet Cable
Quick Installation Guide
Power Adapter



For more information, please visit

<http://www.tp-link.com/en/products/details/?model=TD-W8960N>

or scan the QR code left

Specifications are subject to change without notice. TP-Link is a registered trademark of TP-Link Technologies Co., Ltd. Other brands and product names are trademarks or registered trademarks of their respective holders. Copyright ©2017 TP-Link Technologies Co., Ltd. All rights reserved.

www.tp-link.com

TP-Link 300Mbps Wireless N ADSL2+ Modem Router TD-W8960N